

# The Federally Qualified Health Center

What it will look like in La Plata County



# The Plan

- HRSA Application submitted December 13.
- We should hear if we are funded by August 1.
- We will have 120 days from the award to open the clinic.
- We have designed a clinic for the Riverside Building and secured the space to be renovated upon notice of award.
- Renovation costs will be \$440,000 for 3,956 Sq. Ft.
- There is a two year start-up period for the clinic.
- We have applied for a Community Health Center with the Homeless as a special population.

# FQHC Floor Plan

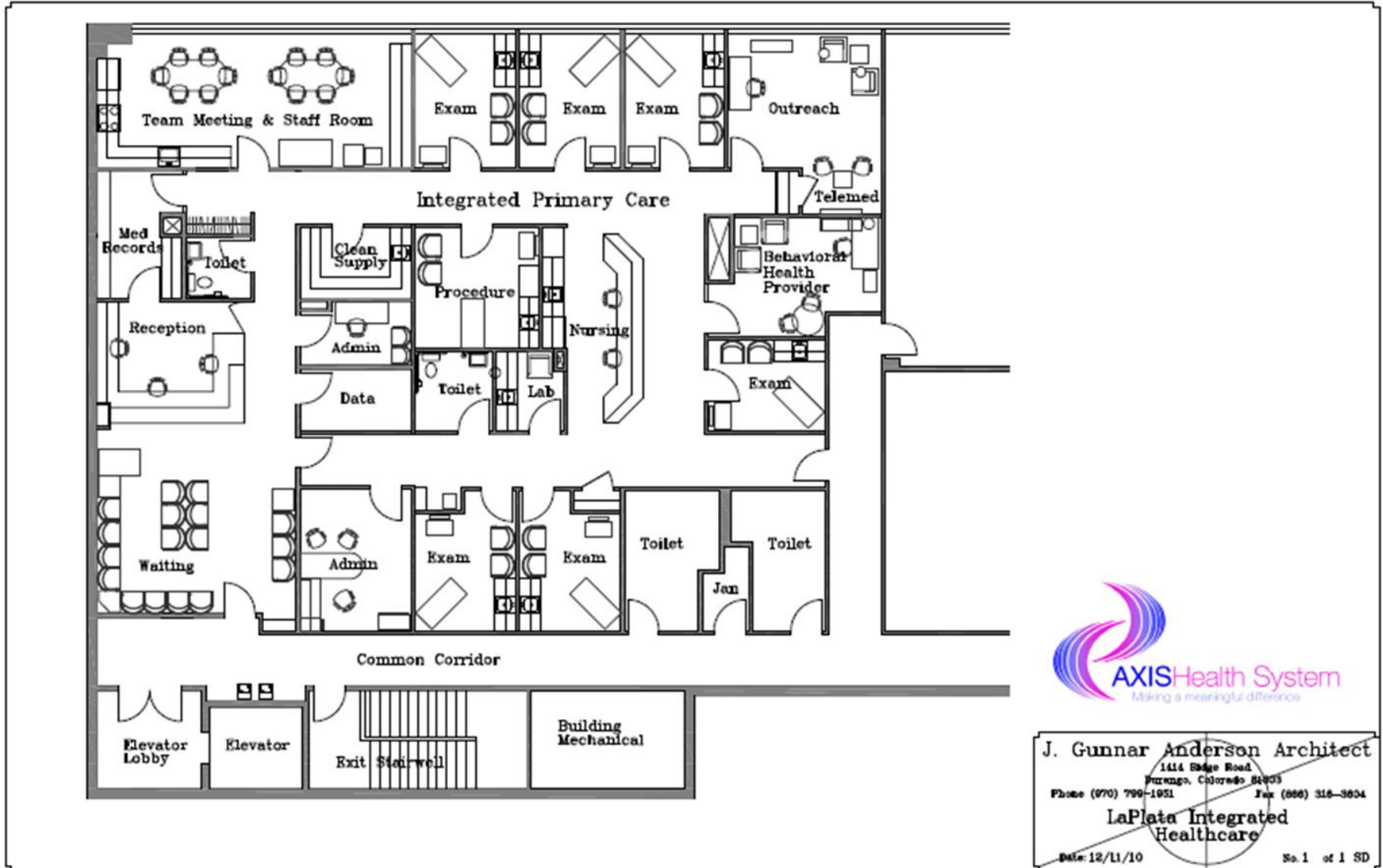

J. Gunnar Anderson Architect  
1414 Stage Road  
Durango, Colorado 81303  
Phone (970) 790-1951 Fax (970) 318-3604  
LaPlata Integrated Healthcare  
Date: 12/11/10 No. 1 of 1 SD

# Projected Patients and Encounters

Year 1			Year 2			Year over Year % Change	
	Community Health	Homeless	Total	Community Health	Homeless	Total	
Total Encounters	5,990	760	6,750	7,784	836	8,620	27.7%
Patient Projections	2,150	100	2,250	2,815	110	2,925	30.0%

# Clinical Staff

Staff Category	Year 1 FTEs	Year 2 FTEs
Family Physicians	1.10	1.40
Physician Assistant/NP	0.50	0.60
Nurses - RNs	0.50	0.80
Nurses - LPNs	0.70	1.20
Clinical Support Staff (Medical Assistants, etc)	0.70	1.20
Behavioral Health Specialists (BH Providers)	0.50	0.80
Psychiatrists	0.05	0.10
Outreach (Outreach Staff)	1.00	1.25

# Clinical Outcomes

- Adult Diabetes-lower HbA1c
- Cardiovascular Disease-Hypertension
- Cancer Screening-Pap Tests
- Prenatal Health-Prenatal Care in First Trimester
- Perinatal Health-Infant Birth Weight
- Child Health-Immunizations
- Behavioral Health-Depression Screening
- Oral Health-Cavity Free at Three
- Adult Obesity-Detection and Intervention
- Behavioral Health Screening of Homeless Population
- Asthma- Self-Management Education

# Required Services

- Services must be provided directly or through formal agreements:
- Medical Services including Prenatal Care
- Lab and X-ray
- Pharmacy
- Behavioral Health
- Oral Health
- Outreach

# Questions?

